

£1,350 Per Month
The Hedgerows
Stevenage, SG2 7DQ

PROPERTY SUMMARY

Putterills Lettings are delighted to offer this lovely detached two-bedroom unfurnished house in the Chells Manor area. The property comprises Lounge, a kitchen/dining area with patio doors leading to the garden. Two double bedrooms and a bathroom with shower over. The property further benefits from a rear garden and an allocated parking space.

2



1



2









Ground Floor

Approx. 32.4 sq. metres (348.7 sq. feet)

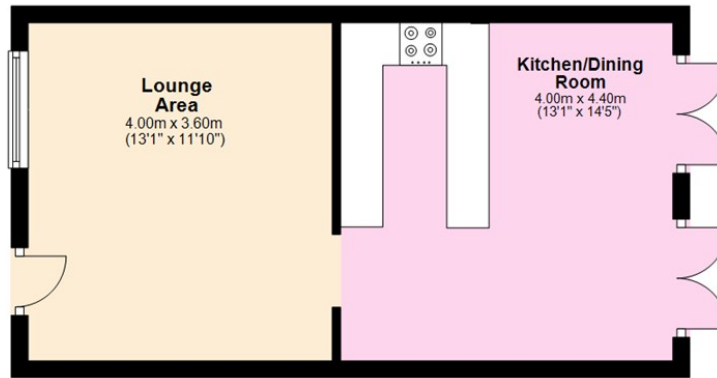

First Floor

Approx. 29.1 sq. metres (313.3 sq. feet)

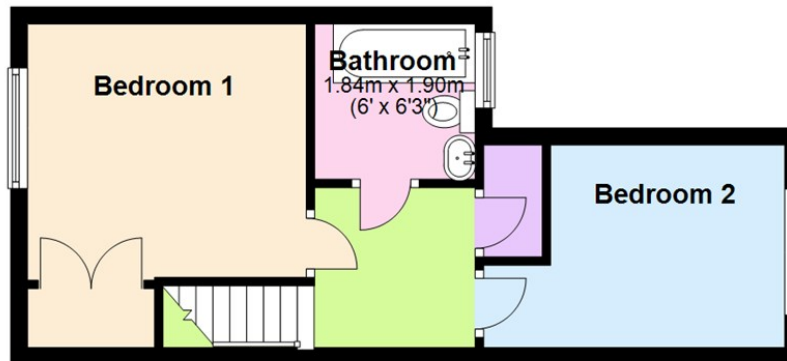

Total area: approx. 61.5 sq. metres (662.0 sq. feet)

Approximate measurements not to scale for room identification purposes only
Plan produced using PlanUp.

LOCAL AUTHORITY

TENURE

COUNCIL TAX BAND

B

VIEWINGS

By prior appointment only

Energy Efficiency Rating		
	Current	Potential
Very energy efficient - lower running costs		
(92 plus) A		
(81-91) B		
(69-80) C		
(55-68) D		
(39-54) E		
(21-38) F		
(1-20) G		
Not energy efficient - higher running costs		
England & Wales		EU Directive 2002/91/EC

Agents Note: Whilst every care has been taken to prepare these particulars, they are for guidance purposes only. All measurements are approximate and are for general guidance purposes only and whilst every care has been taken to ensure their accuracy, they should not be relied upon and potential buyers/tenants are advised to recheck the measurements



OFFICE ADDRESS

Putterills Lettings
123 London Road
Knebworth
SG3 6EX

OFFICE DETAILS

01462 419333
lettings@putterills.co.uk
www.putterills.co.uk